

WIWA Low Pressure Pumps

Series Rapid 200.01 and Rapid 100.02

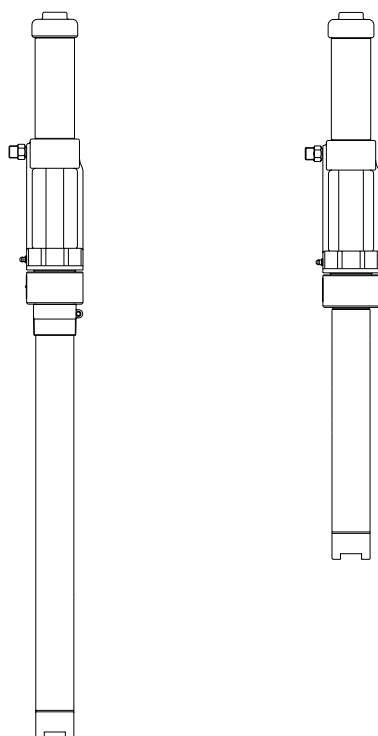

WIWA low pressure pumps Series Rapid ensure dispensing and pumping of almost any type of liquid without loss or spillage.

Field of Application

For Filling purposes only

Transferable materials

Corrosive or non-corrosive fluids, emulsions, dispersions, oils, stains, lacquers, solvents, insecticides, release agents, cutting oils, polyol or any other liquid plus a wide range of chemicals.

Technical Data	Rapid 200.01	Rapid 100.02
Air motor piston stroke (mm)	100	100
Pump ratio	1:1	2:1
Max. free-flow output (ltr./min.)	40	20
Output per cycle (ccm)	200	100
Max. input air (bar)	8	8
Max. operating pressure (bar)	10	16

Order references

Description	Rapid 200.01		Rapid 100.02	
	non-stainless version (N) Order ref./Description	corrosion resistant version (R) Order ref./Description	non-stainless version (N) Order ref./Description	corrosion resistant version (R) Order ref./Description
short version (fluid inlet connection not threaded)	0487899 Model 200.01 N	0487929 Model 200.01 R	0488569 Model 100.02 N	0488607 Model 100.02 R
short version*	0488151 Model 200.01 N-3/4	0488186 Model 200.01 R-3/4	0490229 Model 100.02 N-3/4	0490237 Model 100.02 R-3/4
long version (fluid inlet connection not threaded)	0487953 Model 200.01 N-L	0487945 Model 200.01 R-L	0487422 Model 100.02 N-L	0487503 Model 100.02 R-L

*fluid inlet connection has 3/4" NPT(M) thread

Accessories for WIWA Low Pressure Pumps Series Rapid

Pos.	Description	Order ref.	Rapid 200.01		Rapid 100.02	
			short	long	short	long
01	20 ltr (5 gal) pail and lid assembly, standard	0492264	●		●	
02	20 ltr with cover, galvanized	0492272	●		●	
03	20 ltr (5 gal) lit assembly, standard	0492080	●		●	
04	20 ltr (5 gal) lit assembly, zinc plated	0492078	●		●	
05	Cart (additionally Mounting kit pos. 06 or 07 is required)	0493880	●		●	
06	Mounting kit for Cart	0608939	●			
07	Mounting kit for Cart	0607630			●	
08	Wall bracket	0491942	●	●	●	●
09	Air agitator for 20 ltrs container, less oiler	0491934	●	●	●	●
10	Air agitator for 20 ltrs container, with oiler	0492051	●	●	●	●
11	Fluid Pressure Regulator 0-3 bar with Gauge (Connection for both sides R 1/2" (f))	0492000	●	●	●	●
12	Low Pressure Filter 1/2"	0490385	●	●	●	●
13	Air Regulator with Ball Valve 1/4"	0491764	●	●	●	●
14	Regulator cluster cpl. (consisting of 2 Air Regulators 1/4")	0491756	●	●	●	●
15	Suction assembly for 216 ltrs drum	0491950	●	●	●	●
16	Bung adapter for Rapid 1:1 (included with Long version pump)	0486949	●	●		
17	Bung adapter for Rapid 2:1 (included with Long version pump)	0487589			●	●
18	Fluid hose NW 20 (3/4"), 3 Meter, with Discharge Valve	0492523	●	●	●	●
19	Fluid hose NW 13 (1/2"), 3 Meter, with Discharge Valve	0492485	●	●	●	●
20	Fluid hose NW 20 (3/4"), 3 Meter, without Discharge Valve	0492515	●	●	●	●
21	Fluid hose NW 13 (1/2"), 3 Meter, without Discharge Valve	0492493	●	●	●	●
22	Discharge Valve 3/4" with Elbow	0492582	●	●	●	●
23	Discharge Valve 1/2" with Elbow	0492574	●	●	●	●
24	Tap Gun	0492639	●	●	●	●

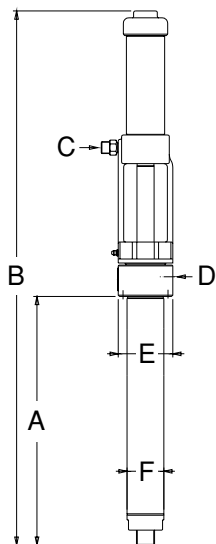

Measurements (in mm)

	Model					
	200.01 short	200.01 short 3/4	200.01 long	100.02 short	100.02 short 3/4	100.02 long
A	354	361	894	358	365	898
B	773	780	1.313	777	784	1.317
C	3/8" NPS(m)	3/8" NPS(m)	3/8" NPS(m)	3/8" NPS(m)	3/8" NPS(m)	3/8" NPS(m)
D	3/8" NPT	3/8" NPT	3/8" NPT	3/8" NPT	3/8" NPT	3/8" NPT
E	ø 80	ø 80	ø 80	ø 80	ø 80	ø 80
F	ø 40	ø 40	ø 40	ø 54	ø 54	ø 54
kg	5,0	5,0	7,0	4,0	4,0	6,5

WIWA

Wilhelm Wagner GmbH & Co. KG
 Gewerbestraße 1-3 • 35633 Lahnau, Germany
 P.O.B. 29 • 35631 Lahnau, Germany
 E-mail: info@wiwa.de • Internet: www.wiwa.de
 Telephone: +49 (0)64 41-6 09-0
 Telefax: +49 (0)64 41-6 09-50/58

Technical changes reserved.

No. 0518182 (e) · 09.03

© Copyright 2001 WIWA Wilhelm Wagner GmbH & Co. KG

Your local distributor is: